



# ALUMINUM MODULAR GRID

## 铝合金模块龙骨

### 产品技术要点 Technical Specification

全贯通凹槽龙骨，45度斜接口 Mitered cut at 45 degrees

### 颜色 Color



### 建议使用场所 Typical Applications

- 办公室 Offices
- 零售商店，商场 Retail stores
- 医疗环境 Healthcare spaces
- 大堂，公共区域 Lobbies, high-level public buildings
- 学校 Education
- 走廊 Corridors

### 产品数据 Physical Data

材质 Material  
优质铝合金 High quality aluminum alloy

表面涂料 Surface Finish  
喷涂 Powder coating

副龙骨/主龙骨连接方式  
Cross Tee / Main Beam Interface  
斜接 Mitered cut

外形 Model  
模块 Modular

负荷等级 Classification  
轻负荷 LD Light duty LD

### 产品代码 Visual Selection

| 产品编号<br>ITEM NUMBER | 模块尺寸<br>EDGE PROFILE | 产品说明<br>DESCRIPTION | 尺寸与厚度<br>DIMENSIONS |
|---------------------|----------------------|---------------------|---------------------|
|---------------------|----------------------|---------------------|---------------------|

### 铝合金模块龙 Aluminum Grid Modular骨

|                 |           |   |              |
|-----------------|-----------|---|--------------|
| BP4740084S24*** | 1200×1200 | 凹槽主龙骨 斜切口间距<br>-1200mm<br>Modular Main Beam<br>Notched -1200mm OC | 3600×32×45mm |
| BP4730084M      | 1200×1200 | 凹槽副龙骨<br>Modular Cross Tee  | 1200×32×45mm |
| BP743054CA      | 1200×1200 | 35H C型龙骨<br>35H C Channel Cross Tee                               | 1200×11×35mm |

### 边龙骨 Molding

|           |                          |                   |
|-----------|--------------------------|-------------------|
| BPT1925HA | 边龙骨<br>Angle Molding     | 3600×19×25mm      |
| BP784008A | 阶梯型边龙骨<br>Shadow Molding | 3600×21×8×10×19mm |

### 配件 Accessories

|        |                        |             |
|--------|------------------------|-------------|
| BP9333 | 铝合金主龙骨接头<br>MB Joinder | 93×33×0.9mm |
| BP7515 | 旋转接头<br>Roll in Clip   | 75×15×0.9mm |

备注：吊筋跨度1200mm

承载：\* 9.8kg/m  
LD \*\* 8.5kg/m  
\*\*\* 9.7kg/m

### 花纹及龙骨安装效果 Detail and Grid Intersections

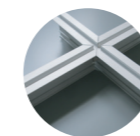

铝合金模块龙骨

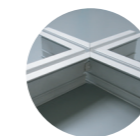

铝合金模块龙骨

### 边龙骨 Molding

BPT1925HA

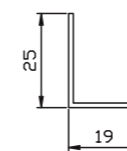

BP784008A

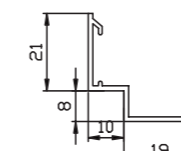

### 详图 Details

45mm凹槽龙骨  
45mm H Modular Beam

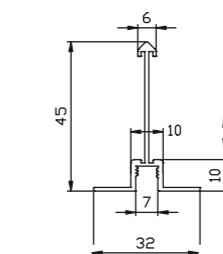

35H C型龙骨  
35H C Channel Cross Tee

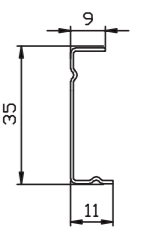

主龙骨连接件  
Main Beam Joinder

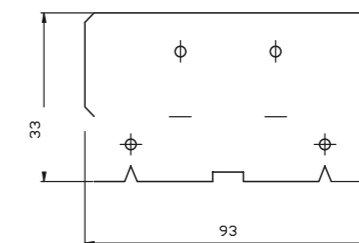

旋转接头  
Roll in Clip

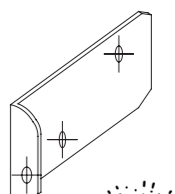

# ALUMINUM MODULAR GRID

## 铝合金模块龙骨

再生材料  
**25%**

### 产品特性 Product Attributes

- High quality aluminum alloy inhibits red rusting  
龙骨系统的安装及设计使之能与阿姆斯壮天花板完美配合并提供和谐一致的表面颜色
- System is engineered and designed to fit perfectly with Armstrong Ceilings  
优质铝合金材料，防锈能力强
- Patent certificate of new utility  
已获得实用新型专利证书
- Mitered cut at 45 degrees: uniformed joints with a black reveal on face  
主龙骨和副龙骨构成主体骨架，配合边龙骨，结构稳定。主、副龙骨45度斜切口，连接后龙骨面部凹槽贯通，立体感强，新颖时尚
- High profile, improved load-carrying capacity  
内槽纹设计，便于切割后安装固定。较高的截面设计，承载能力强
- Rotary stitching on cross tee for improved strength  
垂直截面上有多条加强筋，既增加强度又便于连接件连接



关注阿姆斯壮天花公众号  
获取更多精彩内容

knaufceilingsolutions.com



扫描二维码  
获取详细的产品信息